

Optional Kits available through your Distributor:

Flipper Rebuild Kit (Left) 500-6307-10

Flipper Base Plate Kit (Left) 515-6617-01

Kit includes: Flipper Base Plate (Left) pre-threaded with securing hardware; see the Flipper Drawing for view.

Flipper Rebuild Kit (Right) 500-6307-00

Flipper Base Plate Kit (Right) 515-6617-00

*Kit includes: Flipper Base Plate (Left) pre-threaded with securing hardware; see the Flipper Drawing for view.*Pinball Location Maintenance Standard Kit (for AC/DC Premium Pinball) 502-6002-C7*Standard Kit includes : 8 oz. Novus Wax #2 Fine (Red) (675-0003-01), Cloth, Rubber Rings (used above playfield), Bulbs (Bulb quantities vary and is limited to 25 per type), Fuses (1/per type) and 4 Pinballs. Note: Quanties, sizes and contents subject to change without notice.*Pinball Location Maintenance Deluxe Kit (for AC/DC Premium Pinball) 502-6003-C7*Deluxe Kit includes : Pinball Location Maintenance Standard Kit as described above plus a quantity of Flipper Rebuild Kits. Note: Quantity varies which equals the same quantity of flippers used in this game.***▲ THIS GAME KIT INCLUDES (2) FLIPPER REBUILD KITS ▲**

Plastics*Kit (for AC/DC Premium Pinball) 803-5000-C7

Plastics Kit includes: Plastic Sets (830-6125-XX)

Decals*Kit (for AC/DC Premium Pinball) 802-5000-C4

Decals Kit includes: Decal Set (820-7000-XX)

***Attention:** No individual Plastic or Decal can be ordered separately, unless noted otherwise. Plastics & Decals are subject to change without notice during and / or after production. Key Fobs subject to availability and may or may not be included in the plastic set. All designs, shapes & pieces used subject to change without notice. Kit contents subject to change. Service Bulletin(s) will announce any critical changes, if warranted. The last 2-digits shown on plastics or decals are for reference only.

Ball Shooter (Plunger) Assembly, 500-6146-00-04 (Items 1-6)



Autoplunger Arm Weld Asm., 500-6091-00 (Items 1-5), Autoplunger Coil Assembly, 500-6092-02-ND (Items 6-9) and Shooter Lane Switch Assembly, 500-6096-00 (Items 10-12)

Nr.	AUTOPL. ARM WELD PARTS	QTY.	SPI PART Nr.
1	Arm Weld Assembly	1	515-6526-00
Item 1 is secured to Item 2 by: Retaining Ring, 1/4" ø Shaft (Qty. 1) (270-5002-00)			
2	Autoplunger Fulcrum	1	535-7697-00
3	Nyliner, 1/4" (Thomson #411-FF)	2	545-5423-00
4	Plunger & Link Assembly	1	511-5183-00
Item 4 is secured to Item 1 by: Retaining Ring, 1/4" ø Shaft (Qty. 1) (270-5002-00) For Individual Items use: Plunger 1.81" Lg. (530-5025-05), Plunger Link (545-5293-00) and Roll Pin 1/8" ø x 5/8" Lg. (251-5008-00)			
5	Compression (Return) Spring	1	266-5020-00
(ASM. REF 500-6091-00, Items 1-5)			

Nr.	AUTOPLNGR. COIL PARTS	QTY.	SPI PART Nr.
6	Autoplunger Coil Bracket Assembly	1	515-6527-00
Items 1 & 6 are secured below the P/F by: #8 X 1/2" SHWH AB (Zc.) (Qty. 9) (234-5101-00)			
7	Coil Retainer Bracket	1	535-5203-03
Item 7 is secured to Item 6 by: #8-32 X 1/4" PPH MS (Sems) Zinc (Qty. 2) (232-5300-00)			
8	Coil, 24-940 [NO DIODE]	1	090-5036-ND
COIL DOES NOT REQUIRE A DIODE. SEE COIL NOTE BELOW FOR DETAILS.			
9	Coil Sleeve	1	545-5031-00
(ASM. REF 500-6092-02-ND, Items 6-9)			

Nr.	SWITCH PARTS	QTY.	SPI PART Nr.
10	Switch (for Shooter Lane)	1	180-5157-00
Switch has a Diode (1N4004) (112-5003-00). Can be replaced with (1N4001) (112-5001-00).			
11	Switch Mounting Bracket	1	535-6173-00
Item 11 is secured to Playfield by: #6 X 1/2" SLT HWH AB (Zinc) (Qty. 2) (234-5001-02)			
12	Switch Body Protect Plate	1	535-6539-00
Item 12 is secured to items 10-11 by: #2-56 X 1/2" Unslotted Ser. HWH #4 Head TR3 Black (Qty. 2) (237-5937-02) and #2-56 Hex Nut (Qty. 2) (240-5301-0) (ASM. REF 500-6096-00, Items 10-12)			

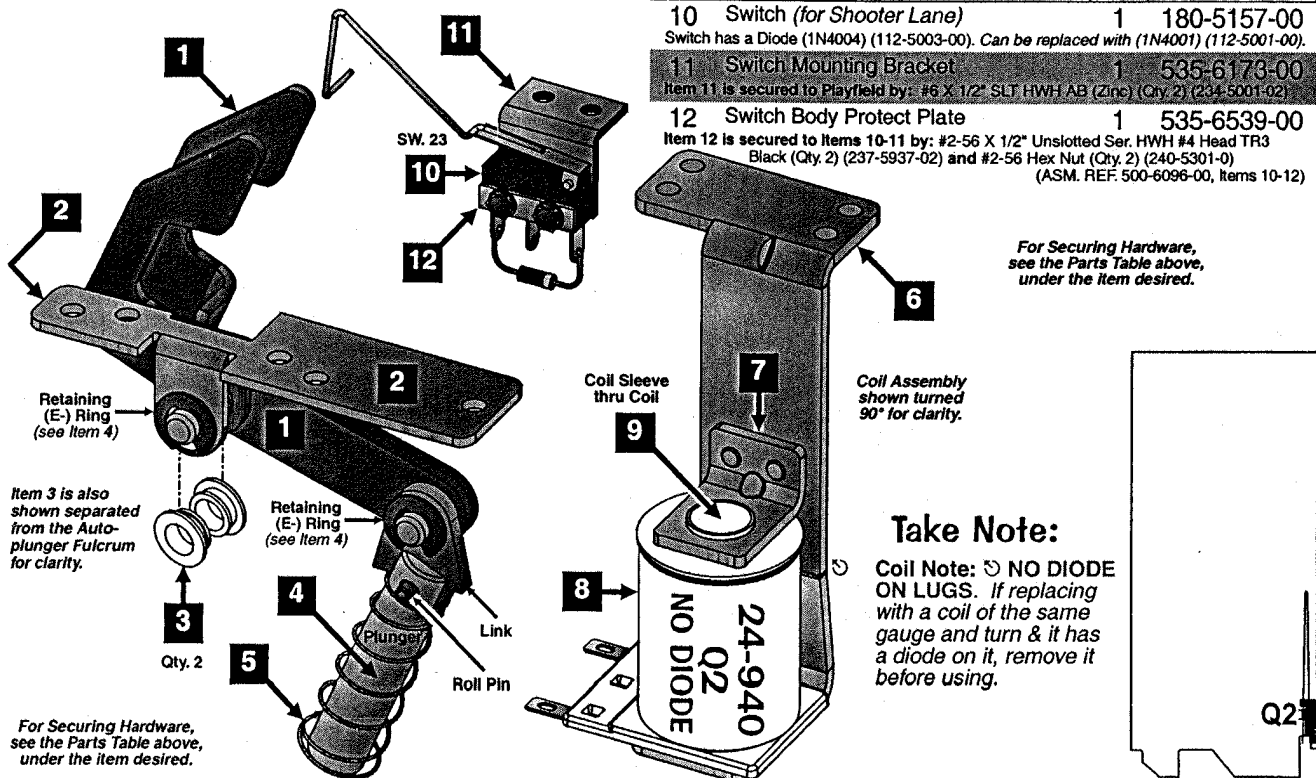

4-Ball Trough Assembly, 500-6318-24-ND (Items 1-13) and Associated Parts: See Parts Table Below.

Ordering Note: Identical to 500-6318-14 with exceptions, see note below Item 13 (Parts Table).

Nr.	4-BALL TROUGH PARTS	QTY.	SPI PART Nr.	Nr.	4-BALL TROUGH PARTS	QTY.	SPI PART Nr.
1	Ball Trough Outhole Mounting Bracket <small>Item 1 is secured below the playfield by: #8 X 1/2" SHWH AB (Zc) (Qty. 4) (234-5101-00)</small>	1	515-6580-01	11	Trough Ball Guide Plate <small>Item 11 is secured to Item 1 by: 1/4" X 5/16" X .144" I.D. Spacer Tap (Qty. 1) (254-5014-03) and #2-58 X 1/2" HWH (Ser) UNS #4HD TR3 BO (Qty. 4) (237-5937-02)</small>	1	535-7801-00
2	Coil Mounting Bracket <small>Item 2 is secured to Item 1 by: #8-32 X 3/8" HWH Swage (Sr.) Zinc (Qty. 4) (237-5975-00)</small>	1	535-7330-01	12	Dual OPTO TRANS Board Assembly	1	515-0173-00
3	Coil Retaining Bracket <small>Item 3 is secured to Item 2 by: #8-32 X 1/4" SHWH (Ser) Zinc (Qty. 2) (237-5975-04)</small>	1	535-5203-03	13	Dual OPTO REC Board Assembly <small>Items 12 & 13 are secured by: #6-32 X 5/8" HWH Swg (Ser) Zc (Qty. 3/per) (237-5976-04) For Individual Items use: Dual OPTO Transmitter Board (Qty. 1) (520-5173-00), Dual OPTO Receiver Board (Qty. 1) (520-5174-00), OPTO PCB Tube Spacer (Brass) (Qty. 3/per) (530-5308-02) and OPTO PCB Rubber Grommet (Qty. 3/per) (545-5518-00)</small>	1	515-0174-00
4	Coil, 26-1200 [NO DIODE] <small>COIL DOES NOT REQUIRE A DIODE. SEE COIL NOTE BELOW FOR DETAILS.</small>	1	090-5044-ND	Ordering Note: If 500-6318-24-ND is unavailable, order the individual part(s) actually required. This assembly is identical to 500-6318-14-ND, -15 or -25 except for the quantity of Items 9 & 10 (Qty. 4/per on 5-Ball Trough) and Item 11, required when a Magnet Mech. is used in the game. -ND means no diode on Item 4, Coil, 26-1200.			
5	Coil Sleeve (Short) (Formost #10-7077)	1	545-5076-01	ASSOCIATED PARTS ARE NOT INCLUDED WITH THE ABOVE ASSEMBLY.			
6	Steel & Nylon Plunger Asm. (3.57")	1	515-7309-01	Nr.	ASSOCIATED PART(S)	QTY.	SPI PART Nr.
7	Compression (Return) Spring	1	266-5020-00	AP-A	Ball Trough Enter / Exit Scoop <small>Item AP-A secured to the playfield by: #8 X 1/2" SHWH AB (Zinc) (Qty. 4) (234-5101-00)</small>	1	535-7329-01
8	Rubber Bumper (Grommet)	1	545-5105-00	AP-B	Steel Balls (1-1/16" ø)	4	260-5000-00
9	Micro Switch (Roller Actuator, Lite-Force) <small>Item 9 requires: Heat Shrink Tubing 1/8" ø PUL-24 (Qty. 1/per) (605-5005-00) Switch has a Diode (1N4004) (112-5003-00). Can be replaced with (1N4001) (112-5001-00).</small>	3	180-5119-02				
10	Switch Body Protect Plate	3	535-6539-00				

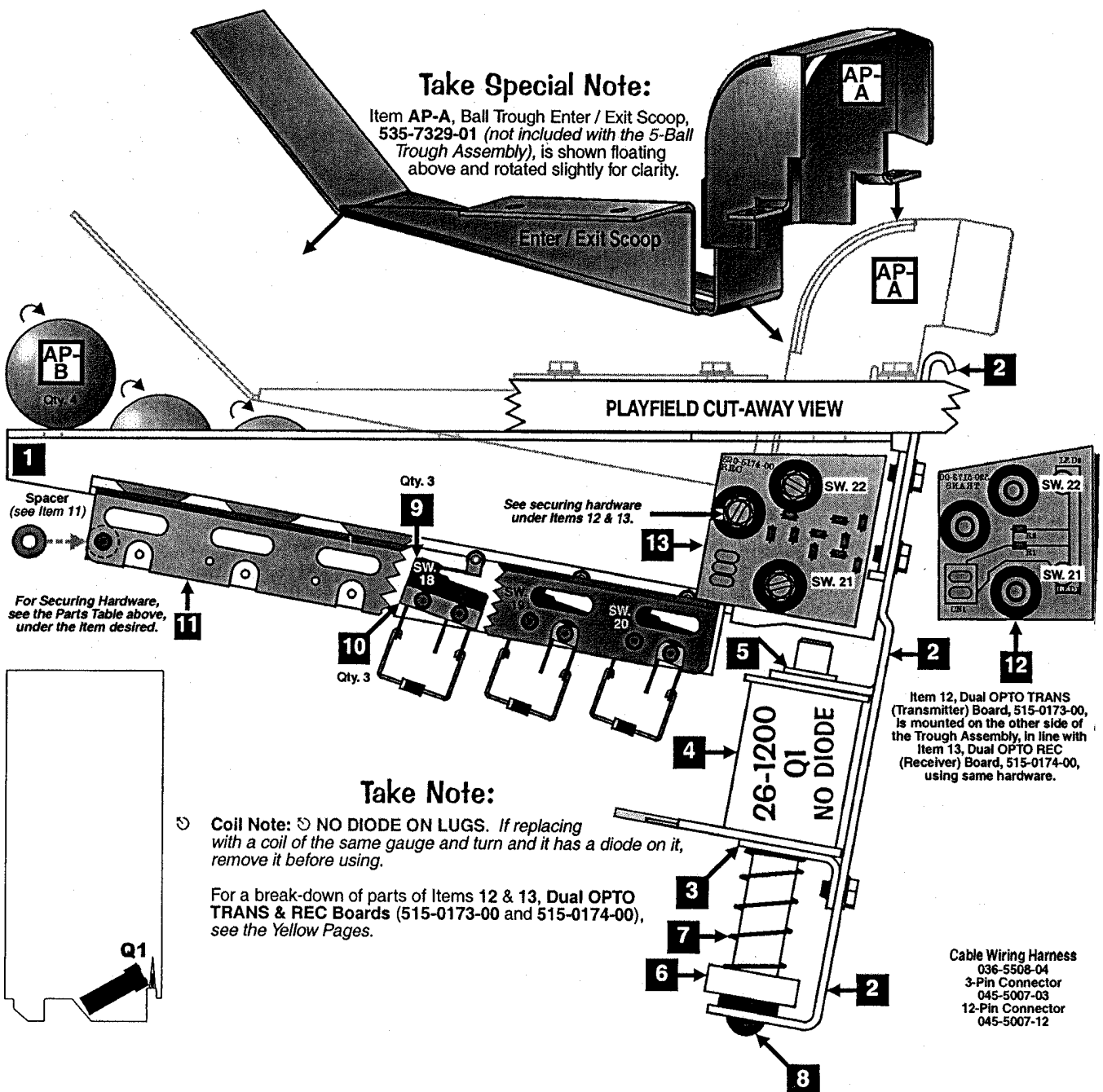

Flipper (Left) Assembly, 500-6543-12-ND (Items 1-15) **and Associated Parts: Yellow Flipper Bat & Shaft Asm., 515-5133-06-06 (Items AP-A / AP-B)**

Nr.	FLIPPER (LEFT) PARTS	QTY.	SPI PART Nr.
1	Flipper Base Plate (LEFT)	1	See FRP1
Item 1 is secured below by: #8 X 1/2" SHWH AB (Zinc) (Qty. 8) (234-5101-00) Ordering Note: Individual Part (535-7275-01) is not prethreaded, see Item FRP1.			
2	Flipper Bat Bushing (White Plastic) 25" ID	1	545-5070-00
Item 2 is secured to Item 1 by: #6-32 X 3/8" HWH Swage (Ser.) Zc. (Qty. 3) (237-5976-02)			
3	Power (EOS / End-of-Stroke) Switch	1	180-5149-00
Item 3 is secured to Item 1 by: #6-32 X 5/8" HWH Swage (Ser.) Zc. (Qty. 2) (237-5976-04)			
4	Sw. Plate/Spring Return Brkt. (LEFT)	1	535-7354-01
5	Flipper Return Spring	1	265-5035-00
6	Coil Stop Bracket Sub-Assembly	1	515-6308-01
Item 6 is secured to Item 1 by: #10-32 X 3/8" SHWH Swage (Ser.) Zinc (Qty. 2) (237-5985-00) and #10 Split Lock Washer (Qty. 2) (244-5003-00)			
7	Spring Washer (17/32" ID X 3/4" X 1")	1	269-5002-00
8	Coil Support Bracket	1	535-7356-00
Item 8 is secured to Item 1 by: #6-32 X 3/8" HWH Swage (Ser.) Zc. (Qty. 2) (237-5976-04)			
9	Coil, 22-1080 [NO DIODE] YEL-GRN	1	090-5032-ND
COIL DOES NOT REQUIRE A DIODE. SEE COIL NOTE BELOW FOR DETAILS.			
10	Coil Sleeve	1	545-5388-00
11	Deflector Pad (Bumper)	1	545-5428-00
12	Flipper Plunger & Link Sub-Assy	1	515-6304-03
For Individual Items use: Flipper Plunger (530-5349-01) and Plunger "Flipper" Link (545-5611-01) and is secured to the Plunger by: Bushing, 16" ID X 281" OD X 167" (Qty. 1) (530-5532-00) and Spiral Pin (532" X 3/4" Lg. (Qty. 1) (251-5015-02)			
13	Crank Bar (Pawl)	1	530-5070-02
Item 13 requires: Bushing, .192" ID X .312" OD X .195" (Qty. 1) (530-5139-00)			
14®	Switch Actuator (LEFT) Sub-Assy	1	515-7257-01
For Individual Items use: Actuator & Spring Bracket (LEFT) (535-9038-01) and Switch Actuator (White Plastic) (545-5612-00) and is secured to the Bracket by: Rivet, 1/8" X 1/4" Lg. (Qty. 1) (249-5003-00)			
15	Set Screw: #10-32 X 3/4" Socket Hd.	2	237-6144-00
Item 15 requires: #10-32 Nylon Stop Nut (Qty. 1) Flipper Link Side Only (240-5203-00) and #10 Split Lock Washer (Qty. 1) Switch Actuator Side Only (244-5003-00) Tool required for Item 15: 5/32" or 4mm Allen Wrench			

Item 14® is also shown separated from Item 13, Crank Bar, for clarity.

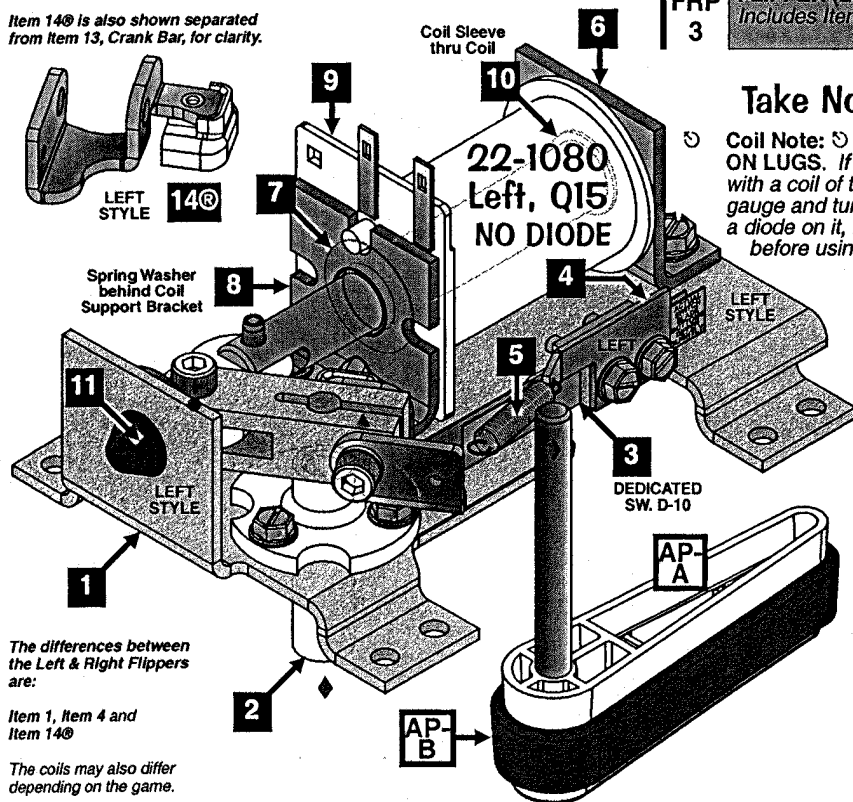

The differences between the Left & Right Flippers are:

Item 1, Item 4 and Item 14®

The coils may also differ depending on the game.

ASSOCIATED PARTS ARE NOT INCLUDED WITH THE ABOVE ASSEMBLY.

Nr.	ASSOCIATED PART(S)	QTY.	SPI PART Nr.
AP-A	Yellow Flipper Bat & Shaft Assembly (Non-Knurled End) without Rubber Ring	1	515-5133-06-06
AP-B	Large Flipper RED Rubber Ring	1	545-5277-22

Flipper Rebuild Parts for Easier Installation, Save \$:

FRP 1 FLIPPER BASE PLATE KIT (LEFT):
Includes Item 1 pre-threaded >+< Securing Hardware for Items 2, 3, 6 & 8. **515-6617-01**

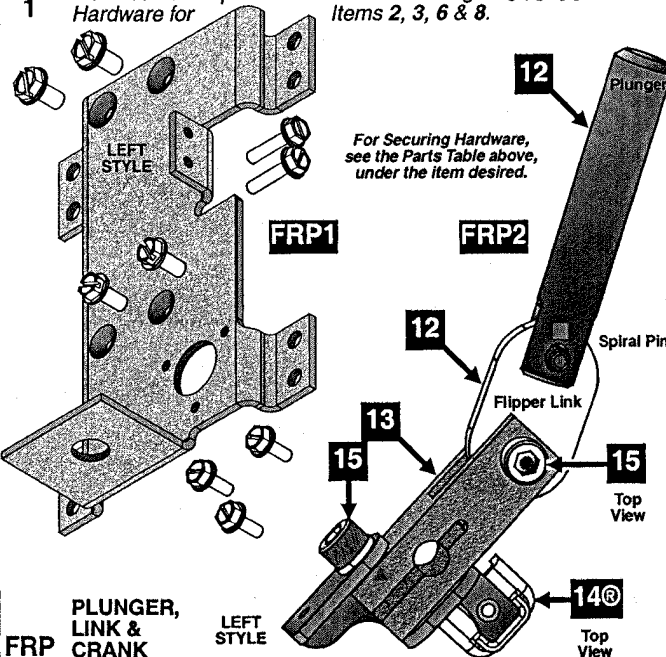

FRP 2 PLUNGER, LINK & CRANK (LEFT STYLE) ASSEMBLY: Includes Items 12, 13, 14 & 15 (comes assembled). **515-7203-01**

FRP 3 FLIPPER (LEFT) REBUILD KIT:
Includes Items 6, 10 AND above FRP2 **500-6307-10**

Take Note:

Coil Note: NO DIODE ON LUGS. If replacing with a coil of the same gauge and turn & it has a diode on it, remove it before using.

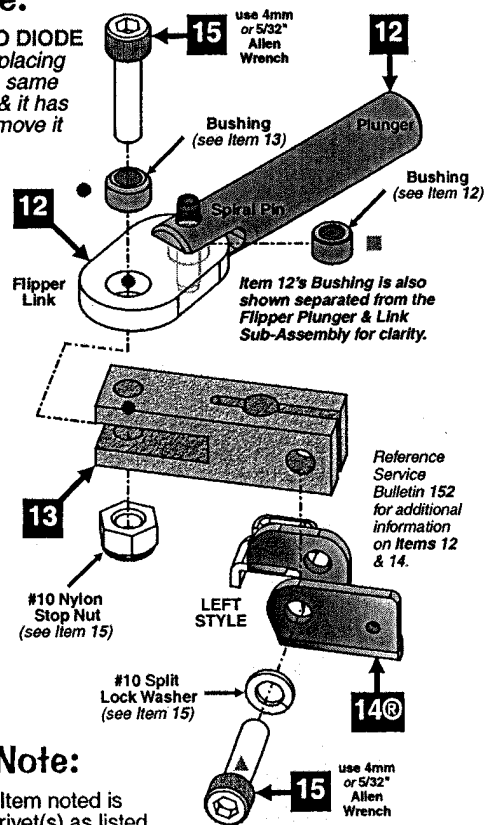

Take Note:

® "R" indicates Item noted is secured with rivet(s) as listed.

Flipper (Right) Assembly, 500-6543-02-ND (Items 1-15) and Associated Parts: Yellow Flipper Bat & Shaft Asm., 515-5133-06-06 (Items AP-A / AP-B)

Nr.	FLIPPER (RIGHT) PARTS	QTY.	SPI PART Nr.
1	Flipper Base Plate (RIGHT)	1	See FRP1
Item 1 is secured below by: #8 X 1/2" SHWH AB (Zinc) (Qty. 8) (234-5101-00) Ordering Note: Individual Part (535-7275-00) is not prethreaded, see Item FRP1.			
2	Flipper Bat Bushing (White Plastic) .25" I.D.	1	545-5070-00
Item 2 is secured to Item 1 by: #6-32 X 3/8" HWH Swage (Ser.) Zc. (Qty. 3) (237-5976-02)			
3	Power (EOS / End-of-Stroke) Switch	1	180-5149-00
Item 3 is secured to Item 1 by: #6-32 X 5/8" HWH Swage (Ser.) Zc. (Qty. 2) (237-5976-04)			
4	Sw. Plate/Spring Return Brkt. (RIGHT)	1	535-7354-00
5	Flipper Return Spring	1	265-5035-00
6	Coil Stop Bracket Sub-Assembly	1	515-6308-01
Item 6 is secured to Item 1 by: #10-32 X 3/8" SHWH Swage (Ser.) Zinc (Qty. 2) (237-5985-00) and #10 Split Lock Washer (Qty. 2) (244-5003-00)			
7	Spring Washer (17/32" ID X 3/4" X 1")	1	269-5002-00
8	Coil Support Bracket	1	535-7356-00
Item 8 is secured to Item 1 by: #8-32 X 3/8" HWH Swage (Ser.) Zc. (Qty. 2) (237-5975-00)			
9	Coil, 22-1080 [NO DIODE] YEL-GRN	1	090-5032-ND
COIL DOES NOT REQUIRE A DIODE. SEE COIL NOTE PREV. PAGE FOR DETAILS.			
10	Coil Sleeve	1	545-5388-00
11	Deflector Pad (Bumper)	1	545-5428-00
12	Flipper Plunger & Link Sub-Assy	1	515-6304-03
For Individual Items use: Flipper Plunger (530-5349-01) and Plunger Flipper Link (545-5611-01) and is secured to the Plunger by: Bushing, 16" ID X .281" OD X .187" (Qty. 1) (530-5532-00) and Spiral Pin (Qty. 1) (251-5015-02)			
13	Crank Bar (Paw)	1	530-5070-02
Item 13 requires: Bushing, .192" ID X .312" OD X .195" (Qty. 1) (530-5139-00)			
14®	Switch Actuator (RIGHT) Sub-Assy.	1	515-7257-00
For Individual Items use: Actuator & Spring Bracket (LEFT) (535-9038-01) and ® Switch Actuator (White Plastic) (545-5612-00) and is secured to the Bracket by: Rivet, 1/8" ID X 1/4" Lg. (Qty. 1) (249-5003-00)			
15	Set Screw: #10-32 X 3/4" Socket Hd.	2	237-6144-00
Item 15 requires: #10-32 Nylon Stop Nut (Qty. 1) Flipper Link Side Only (240-5203-00) and #10 Split Lock Washer (Qty. 1) Switch Actuator Side Only (244-5003-00) Tool required for Item 15: 5/32" or 4mm Allen Wrench			

Item 14® is also shown separated from Item 13, Crank Bar, for clarity.

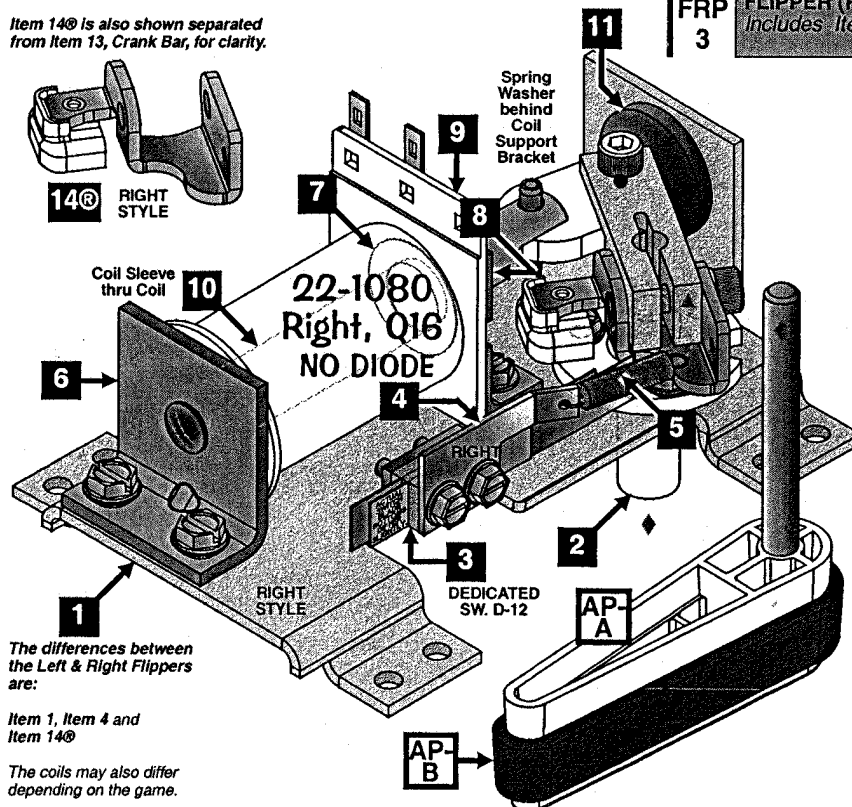

ASSOCIATED PARTS ARE NOT INCLUDED WITH THE ABOVE ASSEMBLY.

Nr.	ASSOCIATED PART(S)	QTY.	SPI PART Nr.
AP-A	Yellow Flipper Bat & Shaft Assembly (Non-Knurled End) <i>without Rubber Ring</i>	1	515-5133-06-06
AP-B	Large Flipper Red Rubber Ring	1	545-5277-22

Flipper Rebuild Parts for Easier Installation, Save \$:

FRP FLIPPER BASE PLATE KIT (RIGHT):
Includes Item 1 pre-threaded >+< Securing Hardware for Items 2, 3, 6 & 8. 515-6617-00

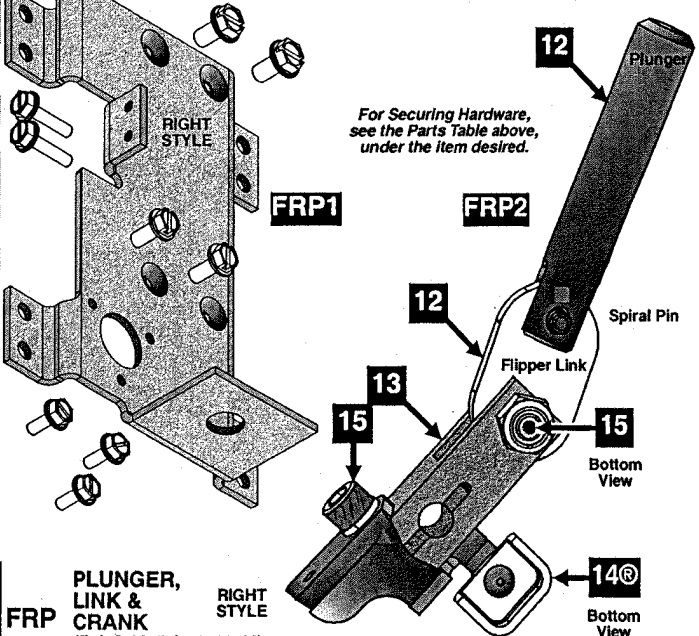

FRP PLUNGER, LINK & CRANK (RIGHT STYLE) ASSEMBLY: Includes Items 12, 13, 14 & 15 (comes assembled). 515-7203-00

FRP FLIPPER (RIGHT) REBUILD KIT:
Includes Items 6, 10 AND above FRP2 500-6307-00

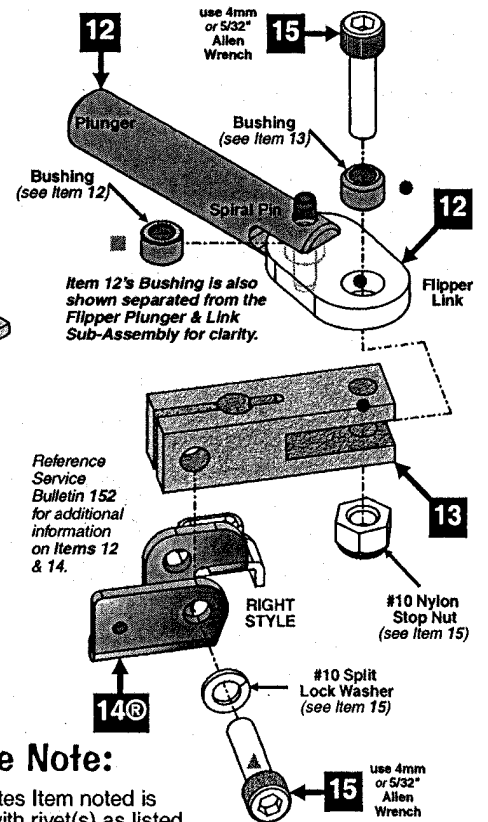

Take Note:

® "R" indicates Item noted is secured with rivet(s) as listed.

Flipper (Left) Assembly, 500-6543-12-ND (Items 1-15) and Associated Parts: Yellow Flipper Bat & Shaft Asm., 515-6275-06 (Items AP-A / AP-B)

Nr.	FLIPPER (LEFT) PARTS	QTY.	SPI PART Nr.
1	Flipper Base Plate (LEFT)	1	See FRP1
Item 1 is secured below by: #8 X 1/2" SHWH AB (Zinc) (Qty. 8) (234-5101-00) Ordering Note : Individual Part (535-7275-01) is not prethreaded, see Item FRP1.			
2	Flipper Bat Bushing (White Plastic) .25" ID.	1	545-5070-00
Item 2 is secured to item 1 by: #6-32 X 3/8" HWH Swage (Ser.) Zc. (Qty. 3) (237-5976-02)			
3	Power (EOS / End-of-Stroke) Switch	1	180-5149-00
Item 3 is secured to item 1 by: #6-32 X 5/8" HWH Swage (Ser.) Zc. (Qty. 2) (237-5976-04)			
4	Sw. Plate/Spring Return Brkt. (LEFT)	1	535-7354-01
5	Flipper Return Spring	1	265-5035-00
6	Coil Stop Bracket Sub-Assembly	1	515-6308-01
Item 6 is secured to item 1 by: #10-32 X 3/8" SHWH Swage (Ser.) Zinc (Qty. 2) (237-5985-00) and #10 Split Lock Washer (Qty. 2) (244-5003-00)			
7	Spring Washer (17/32" ID X 3/4" X 1")	1	269-5002-00
8	Coil Support Bracket	1	535-7356-00
Item 8 is secured to item 1 by: #8-32 X 3/8" HWH Swage (Ser.) Zc. (Qty. 2) (237-5975-00)			
9	Coil, 22-1080 [NO DIODE] YEL-GRN	1	090-5032-ND
COIL DOES NOT REQUIRE A DIODE. SEE COIL NOTE BELOW FOR DETAILS.			
10	Coil Sleeve	1	545-5388-00
11	Deflector Pad (Bumper)	1	545-5428-00
12	Flipper Plunger & Link Sub-Assy.	1	515-6304-03
For Individual Items use : Flipper Plunger (530-5349-01) and Plunger/Flipper Link (545-5611-01) and is secured to the Plunger by: Bushing, 16" ID X .281" OD X .187" (Qty. 1) (530-5532-00) and Spiral Pin a 5/32" X 3/4" Lg. (Qty. 1) (251-5015-02)			
13	Crank Bar (Pawl)	1	530-5070-02
Item 13 requires: Bushing, .192" ID X .312" OD X .195" (Qty. 1) (530-5139-00)			
14	Switch Actuator (LEFT) Sub-Assy.	1	515-7257-01
For Individual Items use : Actuator & Spring Bracket (LEFT) (535-9038-01) and Switch Actuator (White Plastic) (545-5612-00) and is secured to the Bracket by: Rivet, 1/8" X 1/4" Lg. (Qty. 1) (249-5003-00)			
15	Set Screw: #10-32 X 3/4" Socket Hd.	2	237-6144-00
Item 15 requires: #10-32 Nylon Stop Nut (Qty. 1) Flipper Link Side Only (240-5203-00) and #10 Split Lock Washer (Qty. 1) Switch Actuator Side Only (244-5003-00) Tool required for Item 15: 5/32" or 4mm Allen Wrench			

Item 14 is also shown separated from Item 13, Crank Bar, for clarity.

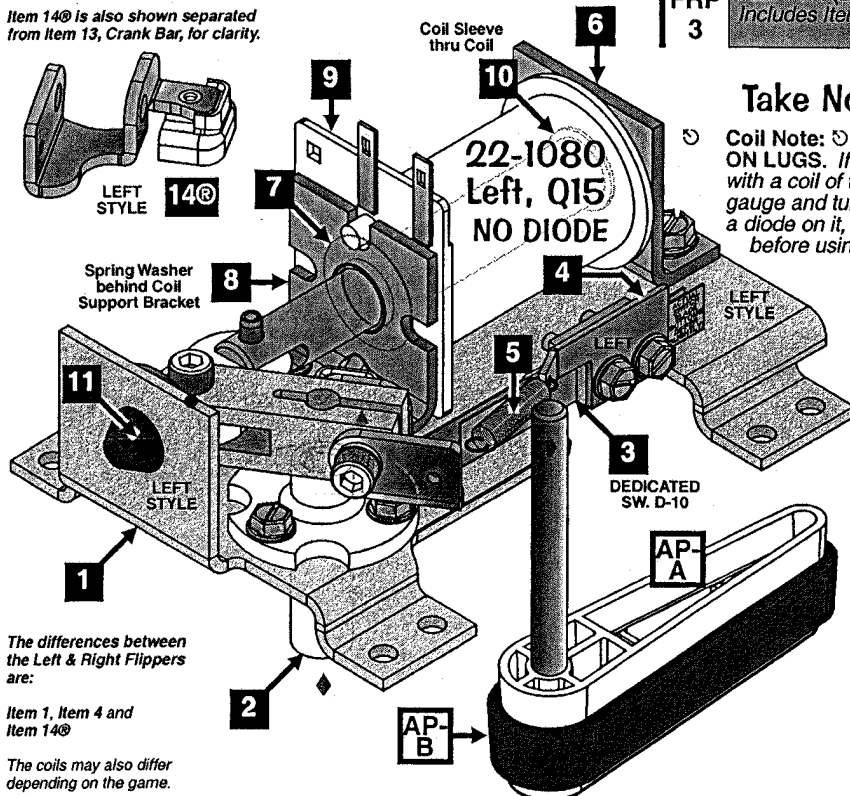

The differences between the Left & Right Flippers are:

Item 1, Item 4 and Item 14

The coils may also differ depending on the game.

ASSOCIATED PARTS ARE NOT INCLUDED WITH THE ABOVE ASSEMBLY.

Nr.	ASSOCIATED PART(S)	QTY.	SPI PART Nr.
AP-A	Yellow Mini Flip Bat & Shaft Assembly (Non-Knurled End) <i>without Rubber Ring</i>	1	515-6275-06
AP-B	Small Flip RED Rubber Ring	1	545-5207-22

Flipper Rebuild Parts for Easier Installation. Save \$:

FRP 1 FLIPPER BASE PLATE KIT (LEFT): Includes Item 1 pre-threaded >+< Securing Hardware for 515-6617-01

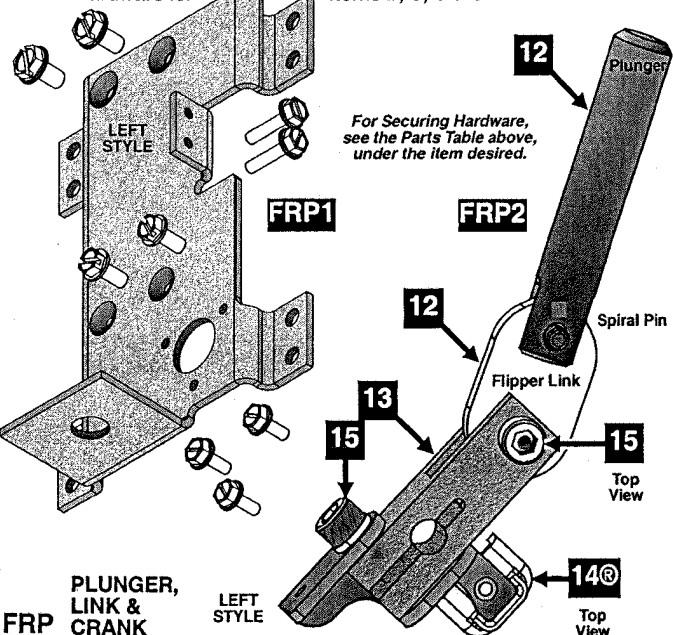

FRP 2 PLUNGER, LINK & CRANK (LEFT STYLE) ASSEMBLY: Includes Items 12, 13, 14 & 15 (comes assembled). 515-7203-01

FRP 3 FLIPPER (LEFT) REBUILD KIT: Includes Items 6, 10 AND above FRP2 500-6307-10

Take Note:

Coil Note: NO DIODE ON LUGS. If replacing with a coil of the same gauge and turn & it has a diode on it, remove it before using.

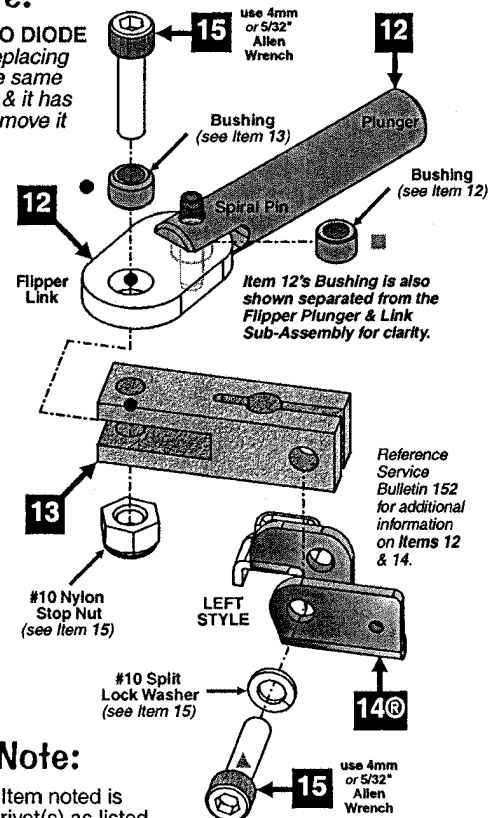

Take Note:

® "R" indicates Item noted is secured with rivet(s) as listed.

Flipper (Right) Assembly, 500-6543-02-ND (Items 1-15) **and Associated Parts: Yellow Mini Flipper Bat & Shaft Asm., 515-6275-06 (Items AP-A / AP-B)**

Nr.	FLIPPER (RIGHT) PARTS	QTY.	SPI PART Nr.
1	Flipper Base Plate (RIGHT)	1	See FRP1
Item 1 is secured below by: #8 X 1/2" SHWH AB (Zinc) (Qty. 8) (234-5101-00) Ordering Note: Individual Part (535-7275-00) is not prethreaded, see Item FRP1.			
2	Flipper Bat Bushing (White Plastic) .25" ID	1	545-5070-00
Item 2 is secured to Item 1 by: #6-32 X 3/8" HWH Swage (Ser.) Zc. (Qty. 3) (237-5976-02)			
3	Power (EOS / End-of-Stroke) Switch	1	180-5149-00
Item 3 is secured to Item 1 by: #6-32 X 5/8" HWH Swage (Ser.) Zc. (Qty. 2) (237-5976-04)			
4	Sw Plate/Spring Return Brkt. (RIGHT)	1	535-7354-00
5	Flipper Return Spring	1	265-5035-00
6	Coil Stop Bracket Sub-Assembly	1	515-6308-01
Item 6 is secured to Item 1 by: #10-32 X 3/8" SHWH Swage (Ser.) Zinc (Qty. 2) (237-5985-00) and #10 Split Lock Washer (Qty. 2) (244-5003-00)			
7	Spring Washer (17/32" ID X 3/4" X 1")	1	269-5002-00
8	Coil Support Bracket	1	535-7356-00
Item 8 is secured to Item 1 by: #8-32 X 3/8" HWH Swage (Ser.) Zc. (Qty. 2) (237-5975-00)			
9	Coil, 22-1080 [NO DIODE] YEL-GRN	1	090-5032-ND
COIL DOES NOT REQUIRE A DIODE. SEE COIL NOTE PREV. PAGE FOR DETAILS.			
10	Coil Sleeve	1	545-5388-00
11	Deflector Pad (Bumper)	1	545-5428-00
12	Flipper Plunger & Link Sub-Assy	1	515-6304-03
For individual items use: Flipper Plunger (530-5349-01) and Plunger/Flipper Link (545-5611-01) and is secured to the Plunger by: Bushing, .16" ID X .281" OD X .187" (Qty. 1) (530-5532-00) and Spiral Pin (5/32" X 3/4" Lg. (Qty. 1) (251-5015-02)			
13	Crank Bar (Pawl)	1	530-5070-02
Item 13 requires: Bushing, .192" ID X .312" OD X .195" (Qty. 1) (530-5139-00)			
14®	Switch Actuator (RIGHT) Sub-Assy	1	515-7257-00
For individual items use: Actuator & Spring Bracket (LEFT) (535-9038-01) and © Switch Actuator (White Plastic) (545-5612-00) and is secured to the Bracket by: Rivet, 1/8" ID X 1/4" Lg. (Qty. 1) (249-5003-00)			
15	Set Screw: #10-32 X 3/4" Socket Hd.	2	237-6144-00
Item 15 requires: #10-32 Nylon Stop Nut (Qty. 1) Flipper Link Side Only (240-5203-00) and #10 Split Lock Washer (Qty. 1) Switch Actuator Side Only (244-5003-00) Tool required for Item 15: 5/32" or 4mm Allen Wrench			

Item 14® is also shown separated from Item 13, Crank Bar, for clarity.

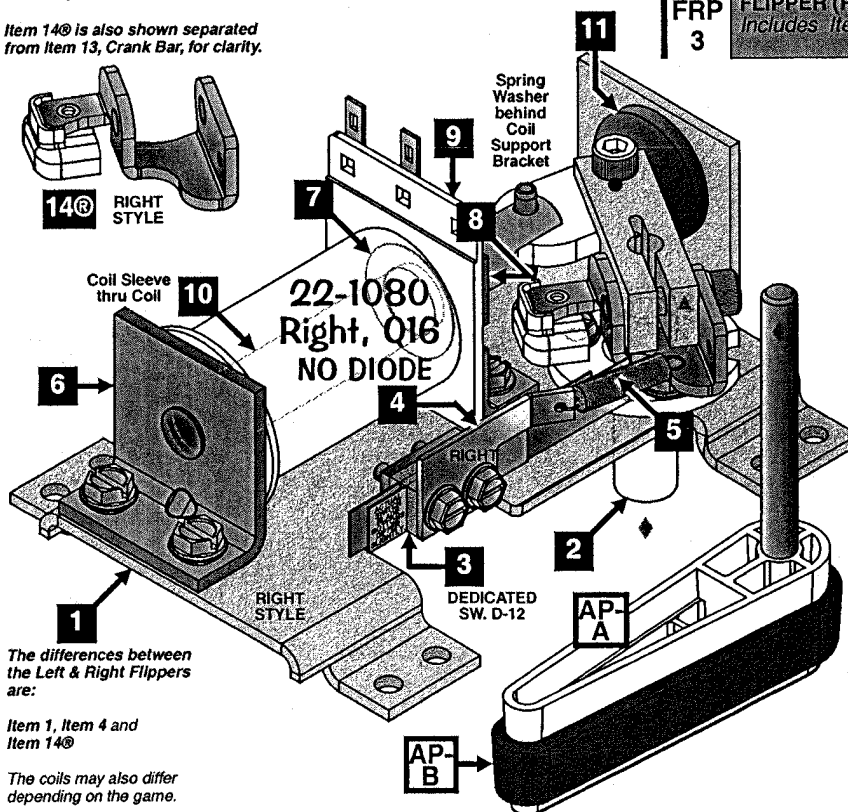

The differences between the Left & Right Flippers are:

Item 1, Item 4 and Item 14®

The coils may also differ depending on the game.

ASSOCIATED PARTS ARE NOT INCLUDED WITH THE ABOVE ASSEMBLY.

Nr.	ASSOCIATED PART(S)	QTY.	SPI PART Nr.
AP-A	Yellow Mini Flip Bat & Shaft Assembly (Non-Knurled End) without Rubber Ring	1	515-6275-06
AP-B	Small Flip RED Rubber Ring	1	545-5207-22

Flipper Rebuild Parts for Easier Installation, Save \$:

FRP 1 FLIPPER BASE PLATE KIT (RIGHT):
Includes Item 1 pre-threaded >+< Securing Hardware for Items 2, 3, 6 & 8. 515-6617-00

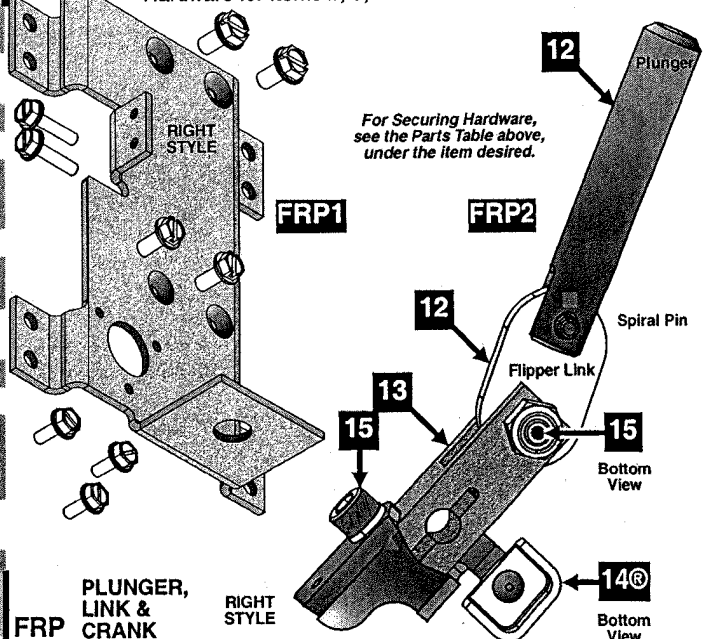

FRP 2 PLUNGER, LINK & CRANK (RIGHT STYLE) ASSEMBLY: Includes Items 12, 13, 14 & 15 (comes assembled). 515-7203-00

FRP 3 FLIPPER (RIGHT) REBUILD KIT:
Includes Items 6, 10 AND above FRP2 500-6307-00

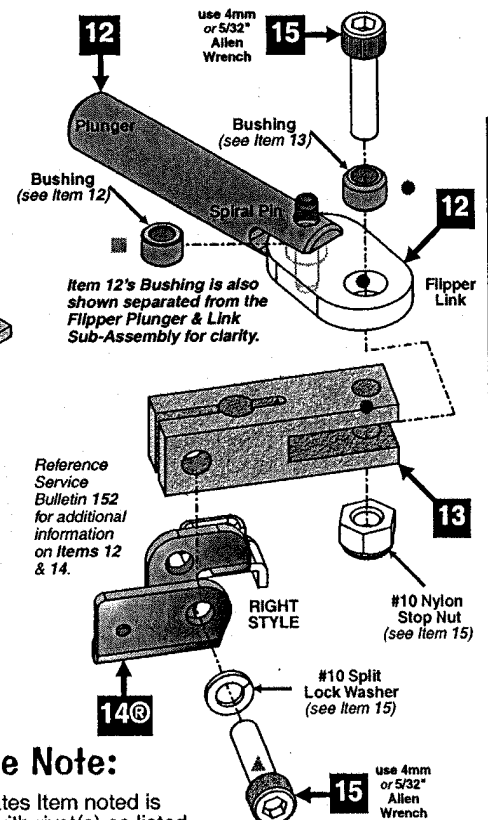

Take Note:

® "R" indicates Item noted is secured with rivet(s) as listed.

Sec. 4: Drawings ...