

Quick Start Guide



ultimorphic
Pinball Evolved

Congratulations on purchasing
a P³, the world's first multi-game
physical pinball platform!

The P³ delivers an evolved pinball experience,
an entire pinball arcade in a single machine.



One machine
Many games
Endless fun![™]



This quick start guide will help you unbox, set up, and operate your new P³ pinball machine, as well as demonstrate simple operational tasks.

Tools Needed:

Utility Knife

9/16" (14mm) Socket or Wrench

5/8" (16mm) Socket or Wrench

Soft Cotton Cloth

For information about changing the upper playfield module or servicing the machine, please visit:
www.multimorphic.com

© 2017 Multimorphic, Inc.

Know Your Machine

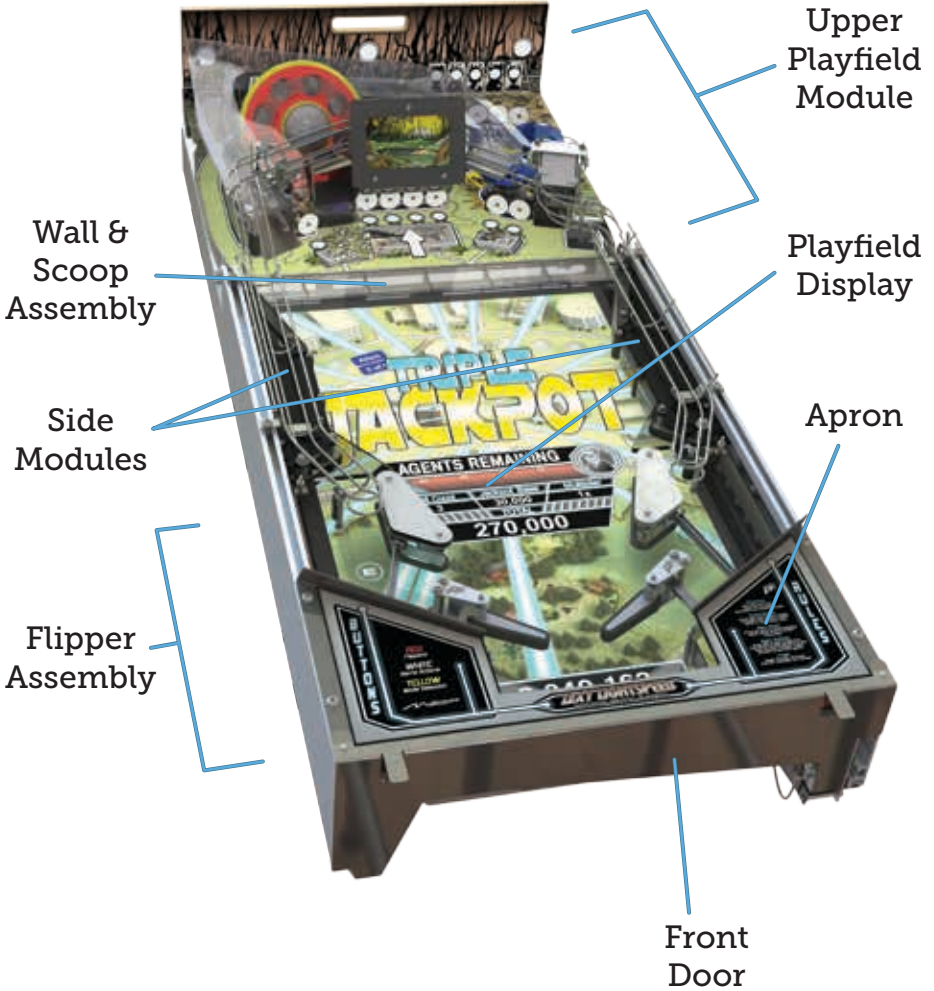



Step 1. Unboxing

If you wish to reuse your shipping box, simply lift the wraparound cardboard upwards and set it aside.



If you do not wish to reuse your shipping box, or if you do not have enough ceiling clearance, lift the wraparound cardboard 5" to clear the bottom tray and use a utility knife to cut down the corner of the wraparound cardboard where the dotted red line is shown below.



Cutting the box farther than 2" from the corner may result in damage to your game.

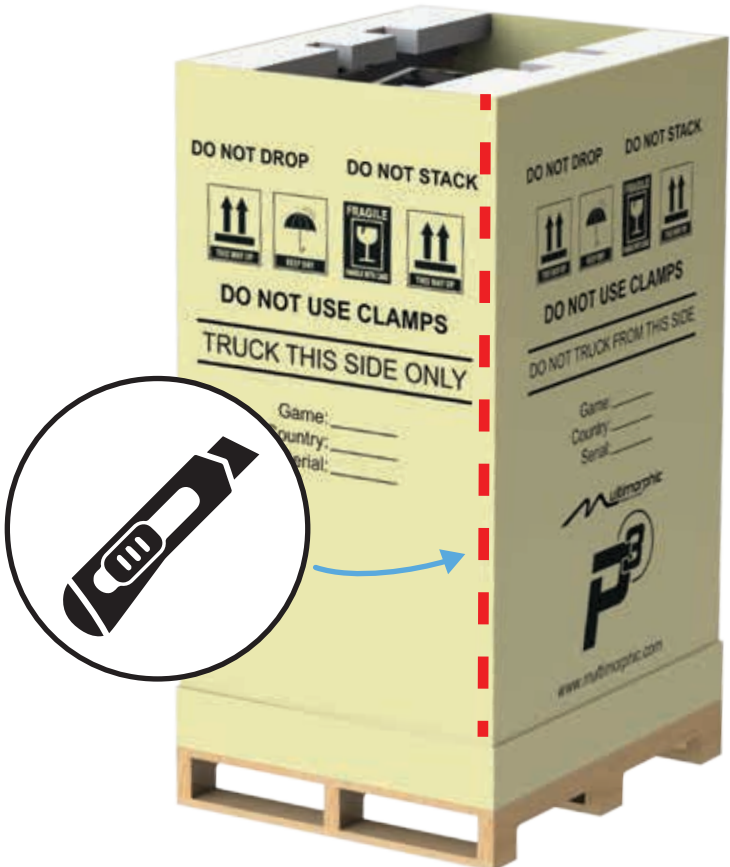

Remove and set aside the two top foam pieces and the four cardboard corners.

Locate and remove the two rectangular boxes at the base of the shipping box.



Warning: Do not cut the strap wrapped around the machine at this time. Doing so will result in damage to your machine.

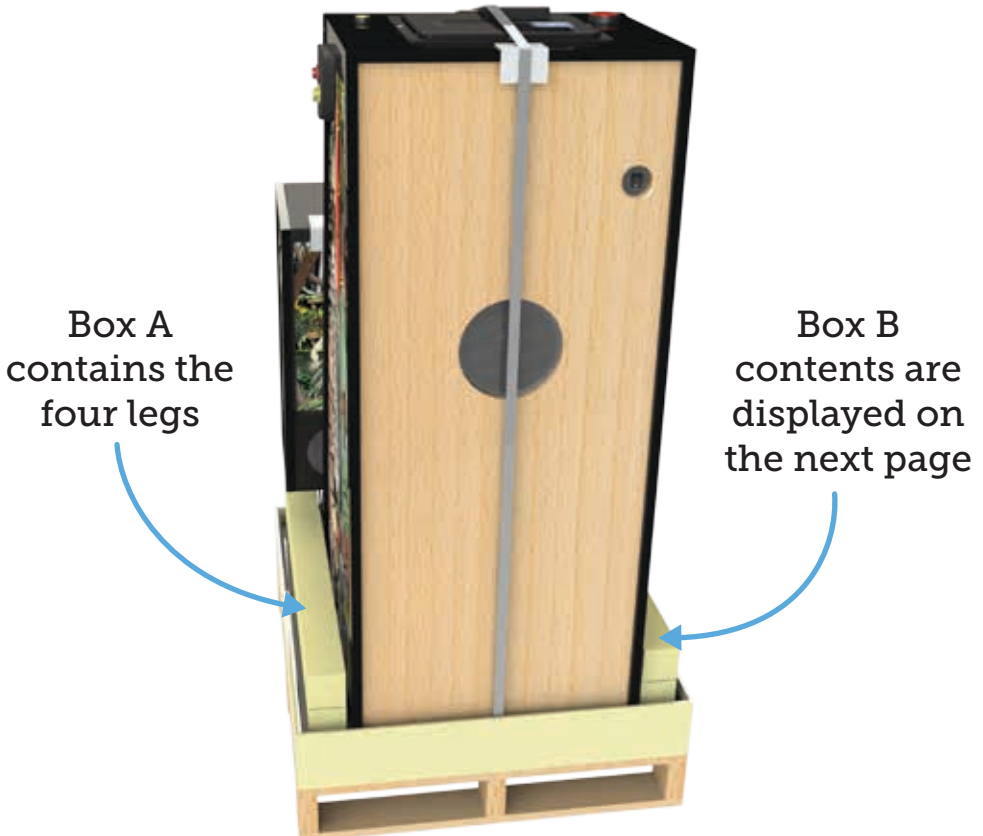

Contents of Box B

Leg Bolt x8



Hinge Bolt x2



Power Cord



Leg Leveler and Nut x4



Pinball x12



Optional Flipper Assembly
Center Post*



Extra Flipper Rubbers
and Slingshot Plastics



*Instructions for installing the center post onto a flipper assembly can be found at www.multimorphic.com.

Step 2. Setup

Install a 3/8" - 16 hex nut onto each of the four leveler feet.



Thread a leveler foot into each of the four legs.



For a standard playfield angle of 6.5° , adjust all of the feet to the same height on each leg. For faster gameplay, the rear feet can be adjusted taller.

Install one leg onto each of the two front corners of the machine using two leg bolts each.

Tighten the bolts with a 5/8" socket or wrench.



Tilt the machine forward until the front legs are resting on the floor.





Single person lifting could cause personal injury. Seek the assistance of at least one other person to perform this step.

With help from at least one other person, lift the rear of the machine, move any remaining shipping material out of the way, and install the two rear legs with two leg bolts each.



Once the rear legs have been installed, set the machine down so that it is standing on all four legs.

Cut the plastic strap that is securing the backbox.



Caution: The strap is under tension and may move unexpectedly when cut.



Lift the backbox up into place and secure it upright with one hinge bolt on either side using a 9/16" socket or wrench.



Caution: Do not deform the hinges by overtightening the bolts.



After tightening these bolts, the hinges should not contact the sides of the cabinet. There should be a gap of about 1/8".

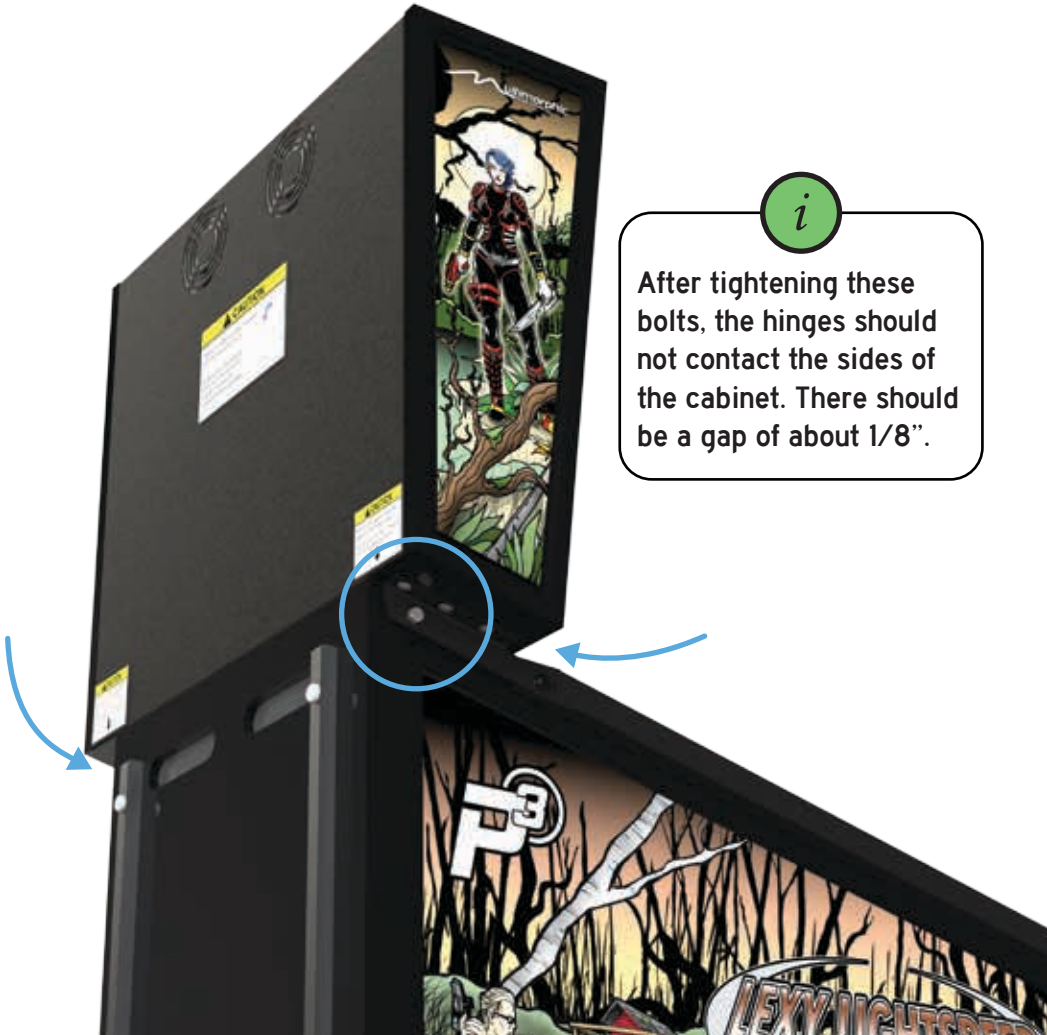

Locate the blue [KEYS] label on the coin door. Remove the label and use the keys to unlock and open the coin door.



Locate the yellow lever inside the cabinet on the upper right and move it to the left to release the lockbar.

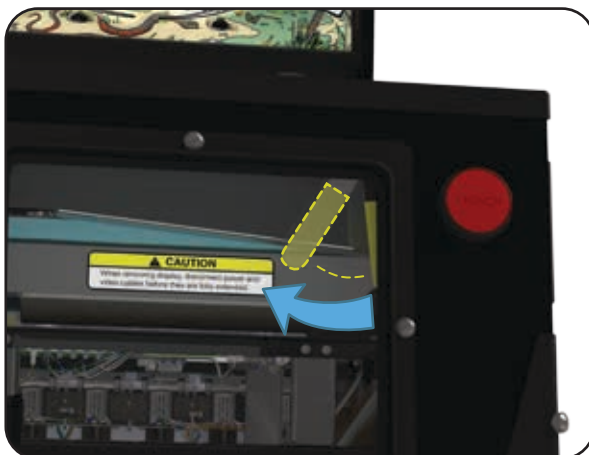

Lift the lockbar from the machine and carefully set it aside.



With the lockbar removed, the glass may slide outwards under gravity. If this occurs, hold it in place and proceed to the next step.



Close and lock the coin door. Then slide the glass out from the front of the machine.

Playfield glass is made from high-strength tempered glass, which is sensitive to extreme temperature shifts and corner nicks. These conditions can cause the glass to shatter. Take care to store the glass on a soft, room temperature surface.



Locate and open the bag containing the pinballs. The balls are coated by a light machine oil which must be removed prior to use.

Using a soft cotton cloth, remove the oil from the surface of each ball. Place the balls onto the playfield, just above the flippers, allowing them to roll down into the drain.

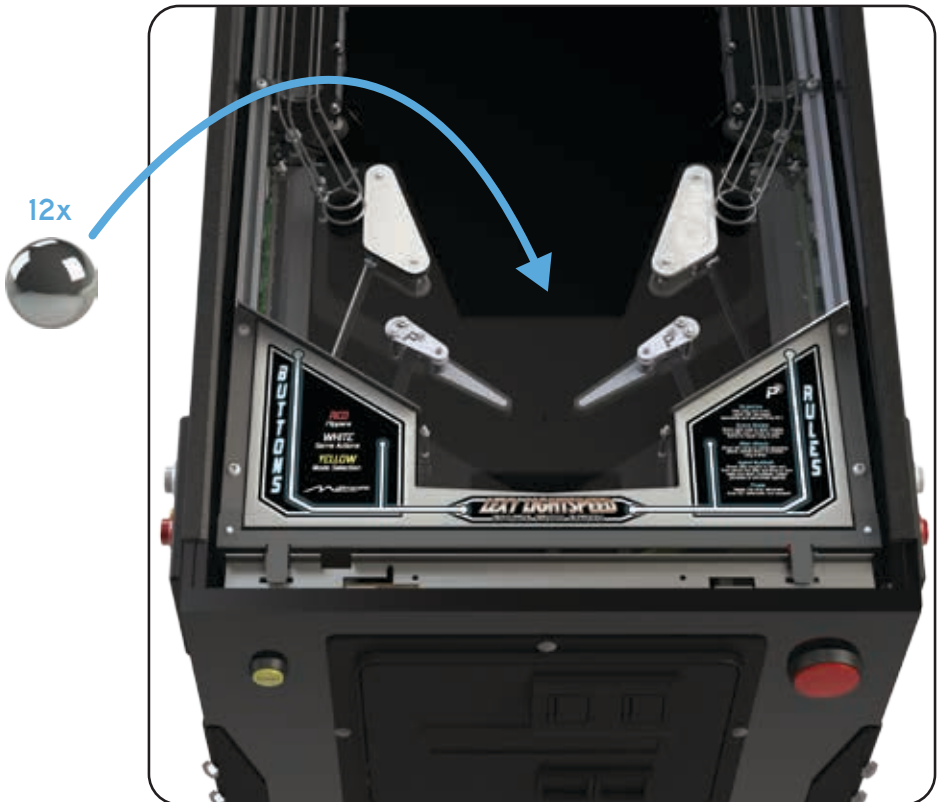

After installing the balls, replace the glass, reinstall the lockbar, and close and lock the coin door.

Install the power cord into the power connector on the back of the machine and connect it to a grounded outlet.



Step 3. Operation

Power on the machine by toggling the switch located on the underside of the cabinet near the front right corner.

i

A few seconds after power-up, the machine will stage the balls into the ball trough. This is a loud process which will finish within about 15 seconds.



When the P³ has completed its startup sequence, the Launcher application will appear, presenting the following apps:

- System Manager (System configuration and application management)
- Diagnostics
- Games

Navigating Menus

Many apps provide menus for choosing options (or launching apps in Launcher). The following buttons are used to navigate these menus:

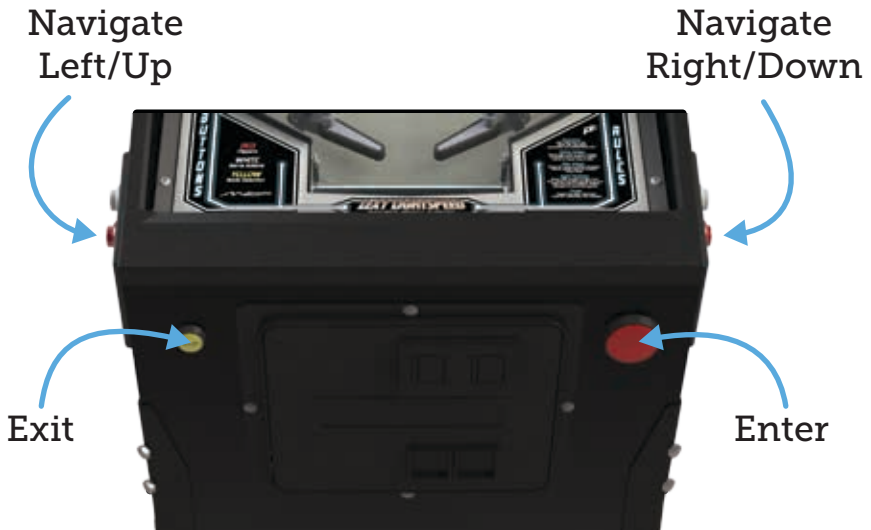

To launch an application:

- Navigate with the red flipper buttons
- Select with the launch button

To leave an application:

- Navigate with the red flipper buttons to the exit option and select with the launch button

or

- Open the coin door
- Press and hold the start button for up to 10 seconds
- Close the coin door

To change the volume of the current application:

- Open the coin door
- Increase the volume with the right red flipper button
- Decrease the volume with the left red flipper button
- Close the coin door

To change application-specific settings:

- Open the coin door
- Press the launch button
- Navigate with the red flipper buttons
- Edit options or enter sub-categories with the launch button
- Change selected option with the red flipper buttons
- Save changes with the launch button or cancel changes with the start button
- Exit sub-categories with the start button
- Close the coin door



Please enjoy your P³!



✉ info@multimorphic.com

🌐 www.multimorphic.com