

# LORD OF THE RINGS® PLAYFIELD SHOT MAP CONTINUED

## Movie Multiballs

Play all 3 *Movie Multiballs* to light **Destroy the Ring** :

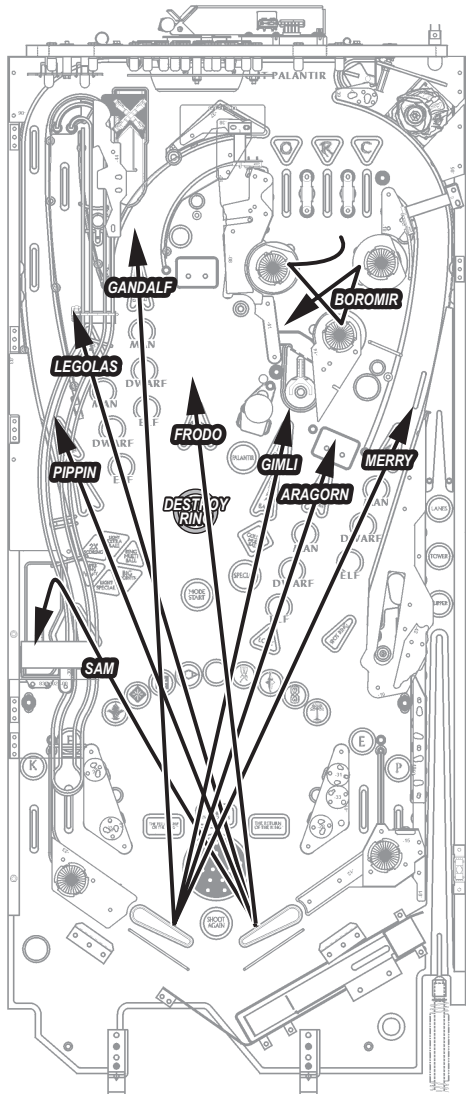

**Movie Multiball**

**The Fellowship of the Ring** Shoot every shot to collect the 9 Members of the Fellowship.

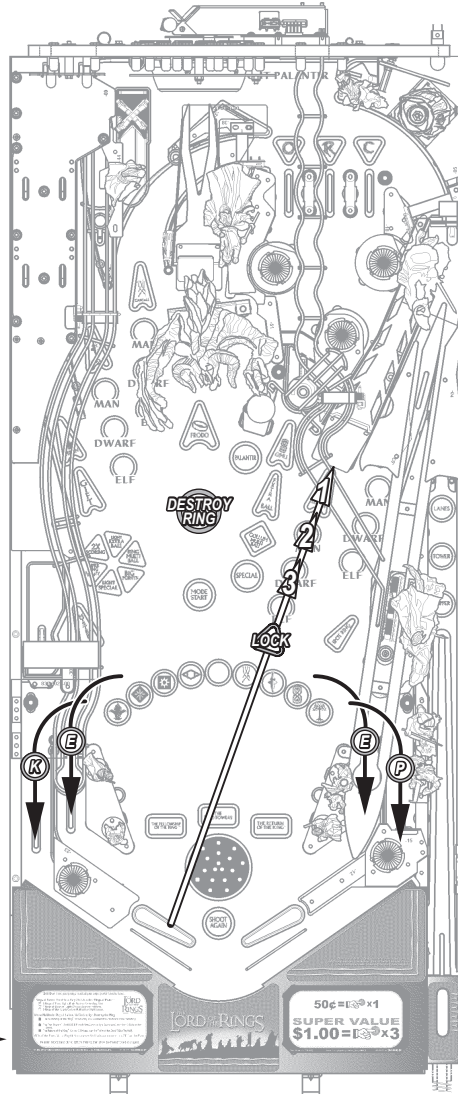

**Movie Multiball**

**The Two Towers** Spell **KEEP** on Bottom Lanes to light **Sword Lock**, then lock 3 Balls on the **Sword**.

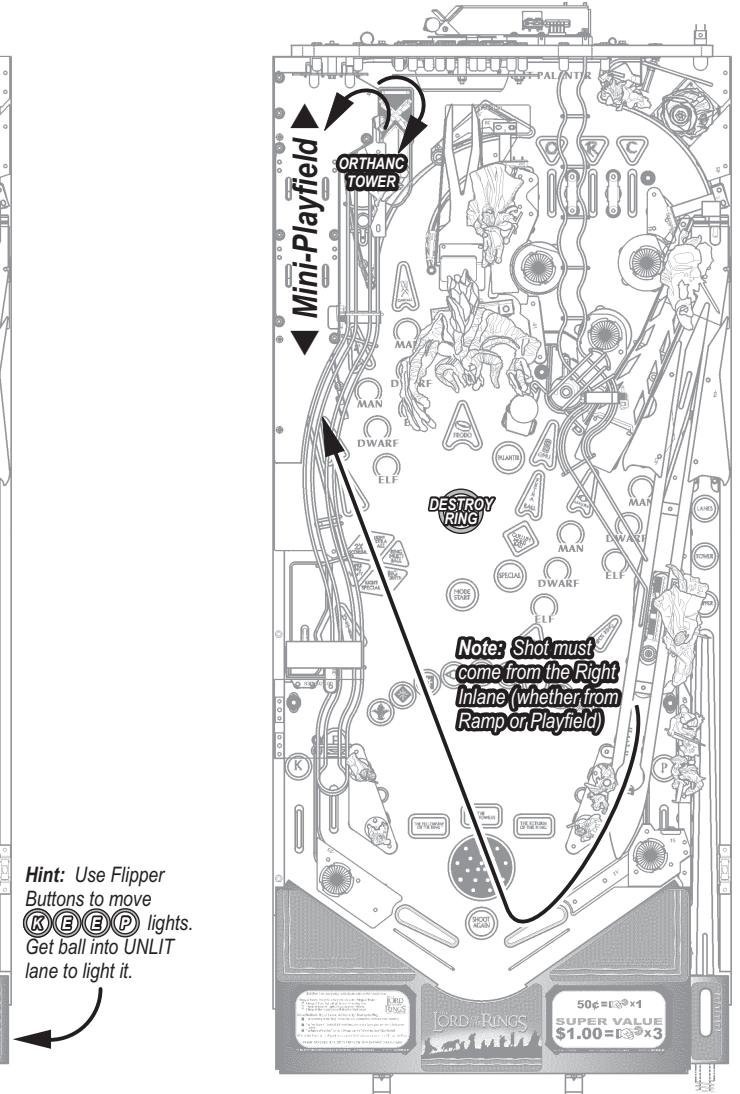

**Movie Multiball**

**The Return of the King** Collect 5,000 souls on the **Paths of the Dead (Mini-Playfield)**

Hint: Use Flipper Buttons to move **KEEP** lights. Get ball into UNLIT lane to light it.

Hint: Use Flipper Buttons to move **KEEP** lights. Get ball into UNLIT lane to light it.

Note: Shot must come from the Right Lane (whether from Ramp or Playfield)

