

8 7 6 5 4 3 2 1

REVISIONS			
REV.	DESCRIPTION	DATE	APPR.
A	MATERIAL WAS 14 GA. (.0747) CRS/ FINISH WAS ZINC CLEAR CHROMATE	01/13/2012	BALCER
B	10-000013-00 WAS 10-0013-00	11/02/2016	WWW

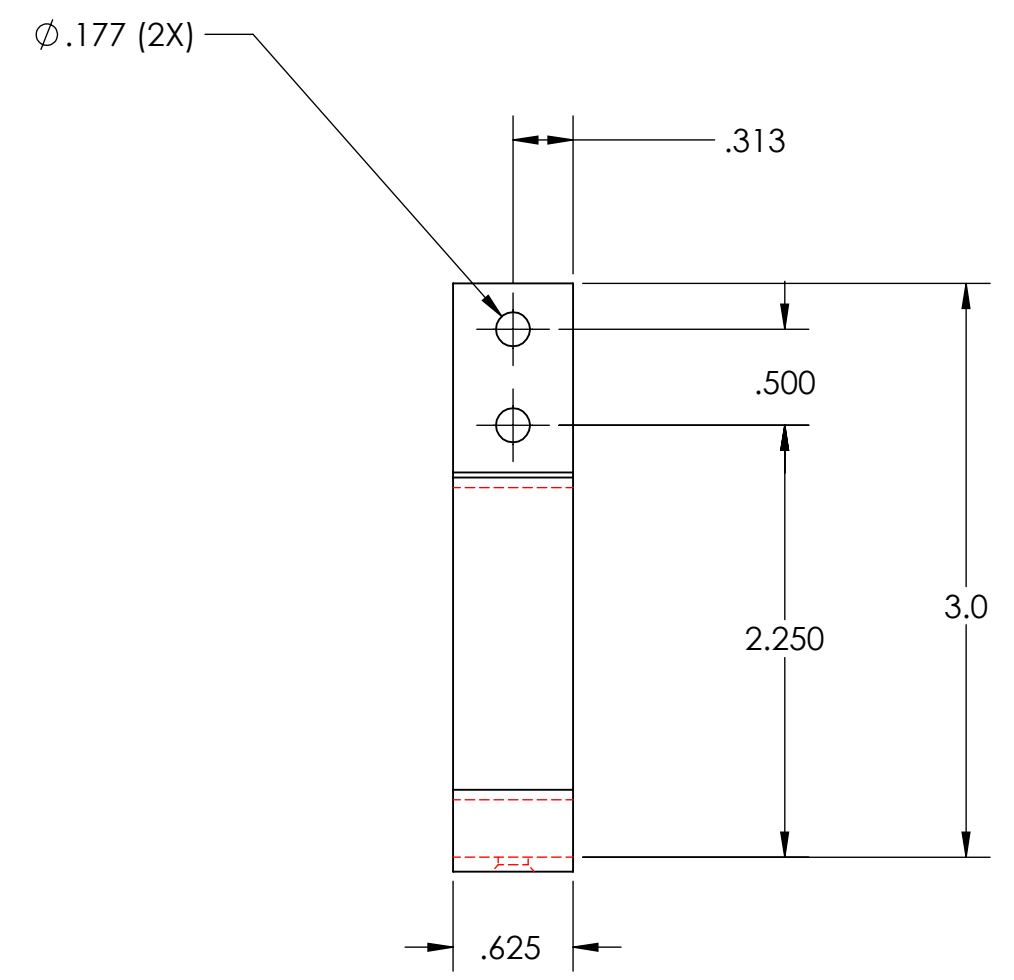
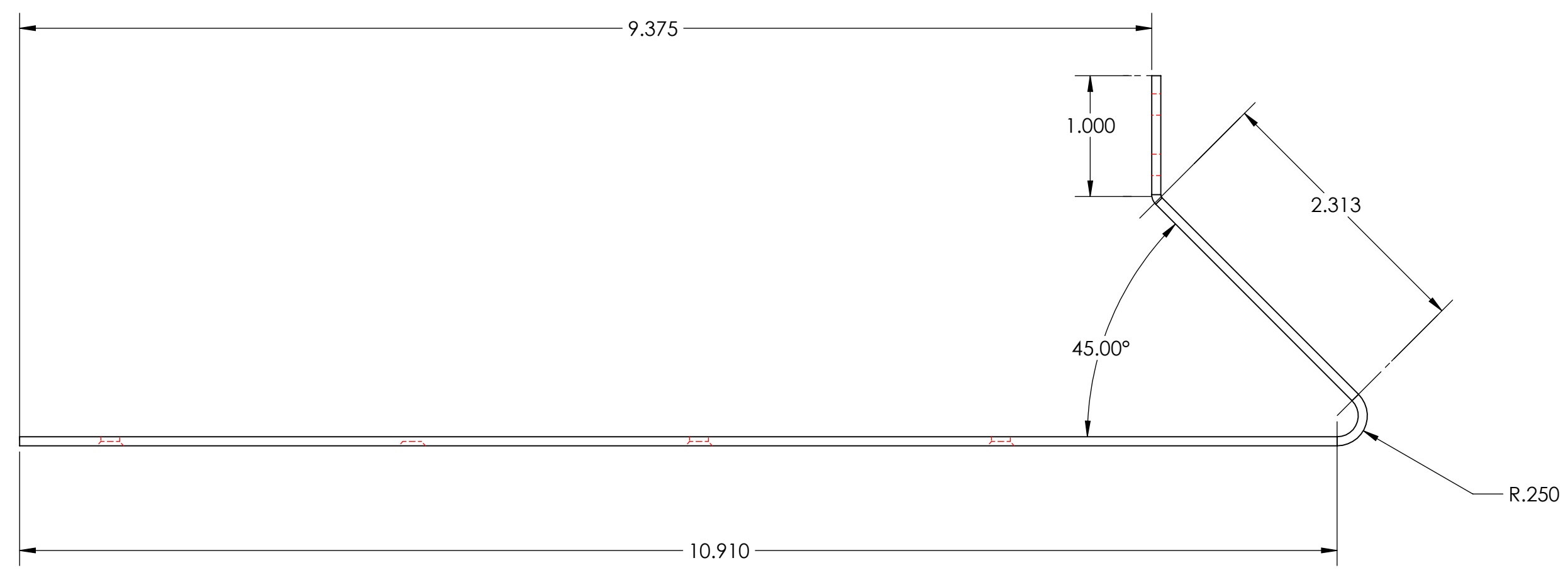
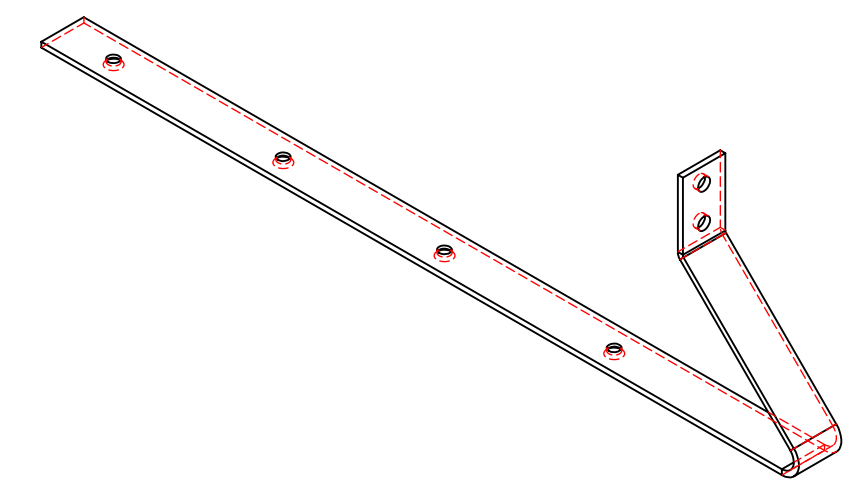
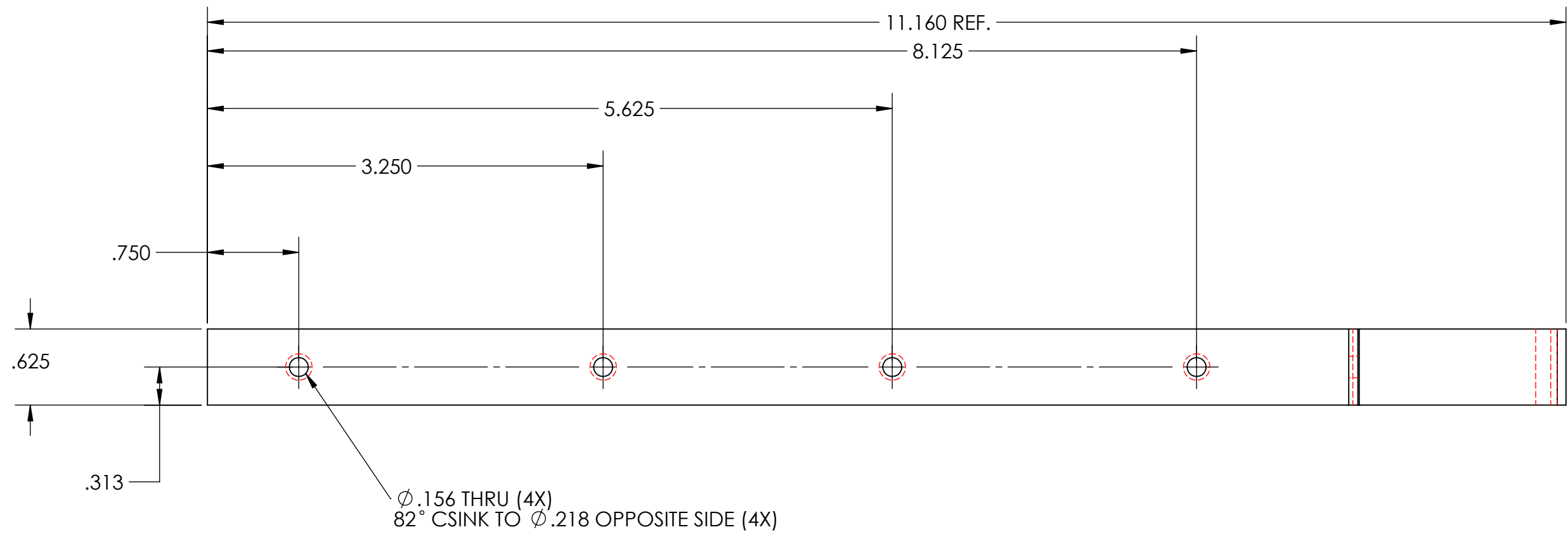

NOTES: PART TO BE FREE OF SHARP EDGES
 MAX. BURR = 3% OF MATERIAL THICKNESS
 MIN. BEND R. ALLOWED (UNLESS SPECIFIED)
 TYP BEND ANGLE = 90° (UNLESS SPECIFIED)

THIS DOCUMENT AND THE DATA DISCLOSED HEREIN OR
 HEREWITH ARE NOT TO BE REPRODUCED, USED OR
 OTHERWISE DISCLOSED IN WHOLE OR IN PART TO ANYONE
 WITHOUT THE WRITTEN CONSENT OF JERSEY JACK PINBALL, INC.

TOLERANCES UNLESS OTHERWISE SPECIFIED: X.X ± .015 HOLES: ± .003 X.XX ± .010 ANGLES: ± 1/2° X.XXX ± .005		APPROVALS		DATE	Jersey Jack Pinball, Inc. 1645 OAK STREET, LAKEWOOD, NJ 08701		
MATERIAL 14 GA. (.0747) X .63 R.E.F.W.		DRAWN BALCER		04/15/2014	TITLE PLAYFIELD SLIDE SUPPORT BRKT		
FINISH BRIGHT ELECTRO-NICKEL		CHECK			SIZE C	DRAWING NO. 10-000013-00	REV B
REQUIRED 1	NEXT ASSEMBLY -	CADREF: 10-000013-00		SCALE 1:1	RELEASE DATE	SHEET 1 OF 1	

8 7 6 5 4 3 2 1